

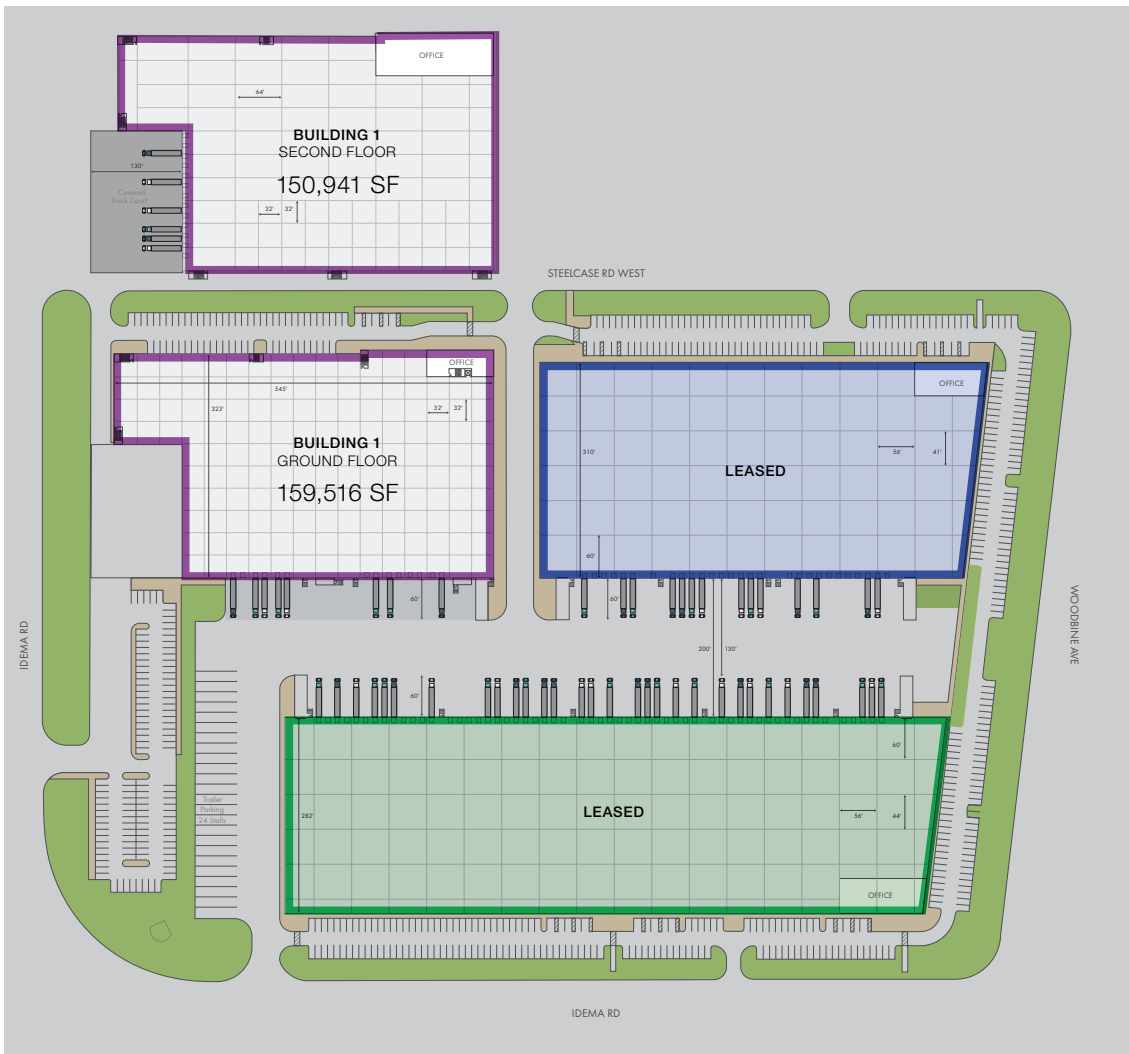

***BUILT
TO
MOVE***

ONE STEELCASE

*QuadReal Property Group, Brokerage



CLEAR HEIGHT

***20' 40'**
BUILDING 1 BUILDINGS 2 & 3

*Measured to underside of beam

TRAILER PARKING SPOTS

24
BUILDINGS 2 & 3

DOCK DOORS

9' x 10'
BUILDING 1 – FLOOR 1 – 14
BUILDING 1 – FLOOR 2 – 12
BUILDING 2 – 28
BUILDING 3 – 53

DRIVE-IN DOORS

12' x 14'*
*BUILDING 1 – 1 (12' X 14')
BUILDING 2 – 2 (14' X 16')
BUILDING 3 – 2 (14' X 16')

BUILDING

WAREHOUSE FLOOR	Building 1 – 6" Slab Building 2 – 9.5" Slab Building 3 – 9.5" Slab
LIGHTING	LED - Warehouse & Office
WAREHOUSE AIR	Building 1 – Wall/Ceiling Mounted Cambridge Gas Fired Units Building 2 & 3 – Roof Mounted Cambridge Makeup Air Units
OFFICE AIR	Rooftop HVAC
POWER	Building 1 – 2000KVA 2500A Building 2 – 1000KVA 1200A Building 3 – 1000KVA 1600A
SPRINKLER	Building 1 – CMDA Building 2 & 3 – ESFR
BAY SIZE	Building 1 – Second floor 64' x 32' Typical – Ground floor 32' x 32' Building 2 – 56' x 41' Building 3 – 56' x 44'
STAGING BAY	Building 1 – Second floor 67' – Ground floor N/A Building 2 & 3 – 60'

DOCK PACKAGE

LEVELER TYPE	Hydraulic
LEVELER CAPACITY	40,000
BUMPERS & SEALS	Yes

EXTERIOR

TRUCK COURT (140' DEEP)	Heavy Duty Asphalt
SHIPPING APRON	7" Reinforced Concrete
PARKING RATIO	0.76/1,000 SF
EV PARKING	Available

BUILDINGS 2 & 3

Targeting LEED® Certification and "Solar-Ready"

Disclaimer: All specifications and depictions contained herein, including the site plan layout, are based on preliminary plans, are subject to change and do not constitute a representation, warranty or covenant of any kind by Landlord/Owner.

